



Tisbury Road

Hove

mishons



Situated in the heart of Hove, between Eaton Road and Church Road, this one bedroom top (third) floor apartment forms part of an attractive period Victorian building and is ideal for a first-time purchase.

Located on the front of the top floor, the apartment is well presented and comprises an open-plan living room with contemporary fitted kitchen, a double bedroom, and a modern bathroom with shower over bath.

Tisbury Road is perfectly positioned for the best of Brighton & Hove, with the cafés, shops, bars and restaurants of Church Road and Blatchington Road just moments away. Hove Lawns and the seafront are easily reached, with St Ann's Well Gardens and Sussex County Cricket Club also close by.

Excellent transport links include regular bus services and Hove station less than half a mile away, offering direct routes to London and Gatwick.

1



1



1



D



Guide Price £230,000 - £240,000

TOTAL FLOOR AREA:

374 sq. ft. (35 sq. m.) approx

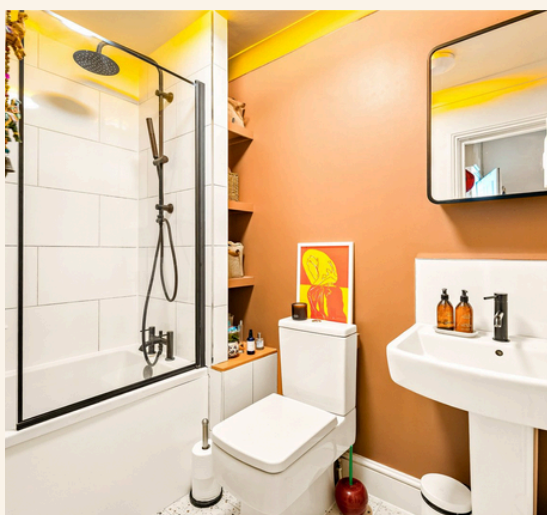
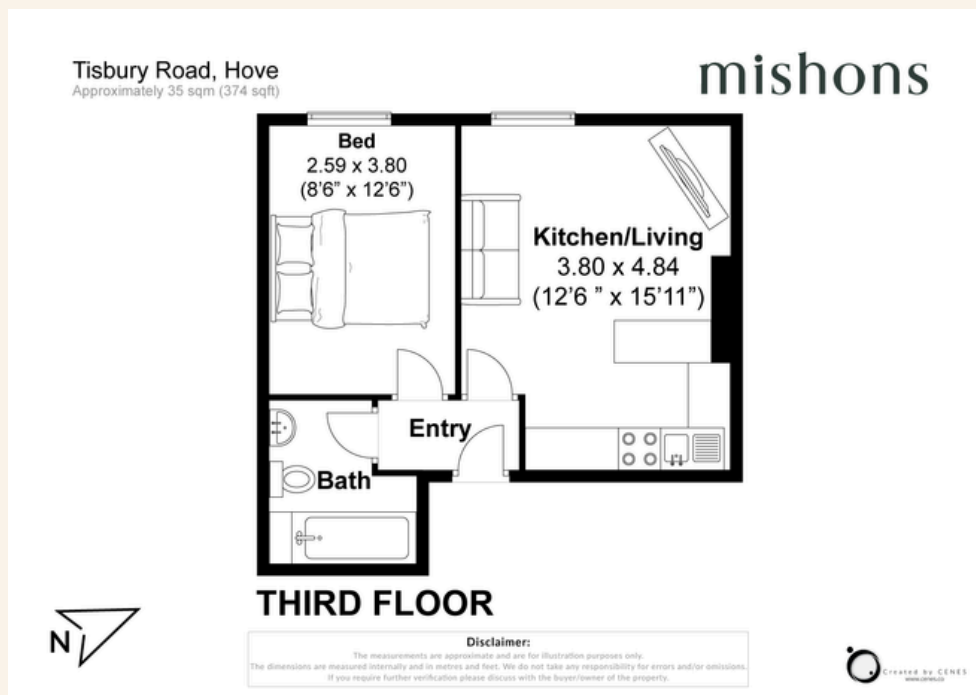



Whatever you're looking for...
We'll help you find it.

mishons

✉ sales@mishons.com

☎ 01273 77 88 77

94 Church Road, Hove, BN3 2EB

Monday-Friday: 8:45 am - 6 pm

Saturday: 9 am - 4 pm

Find us on Facebook and Instagram
@wearemishons or visit mishons.com