



# *Brunswick Terrace*

Hove

mishons



## Stunning Two-Bedroom Apartment with Sea Views Brunswick Terrace, Hove

A beautifully appointed top-floor apartment set within an iconic Grade I listed building on one of Hove's most prestigious Regency crescents.

This elegant two-bedroom residence enjoys a prime seafront position on Brunswick Terrace, directly opposite Hove Lawns and the promenade. The location offers the perfect blend of coastal living and city convenience, with Brighton city centre just moments away, along with an excellent selection of local cafés, bars, restaurants, and boutique shops.

Internally, the property is immaculately presented and boasts a spacious living area, a separate modern fitted kitchen, a contemporary bathroom, and two well-proportioned bedrooms. Large windows flood the space with natural light and offer stunning direct views of the sea.

Ideally located for commuters, Hove mainline station is within easy walking distance, providing direct services to London and excellent links across the South Coast.

➤ *Offers Over* £450,000

2



1



1



C





## TOTAL FLOOR AREA:

884 sq. ft. (82.1 sq. m.) approx

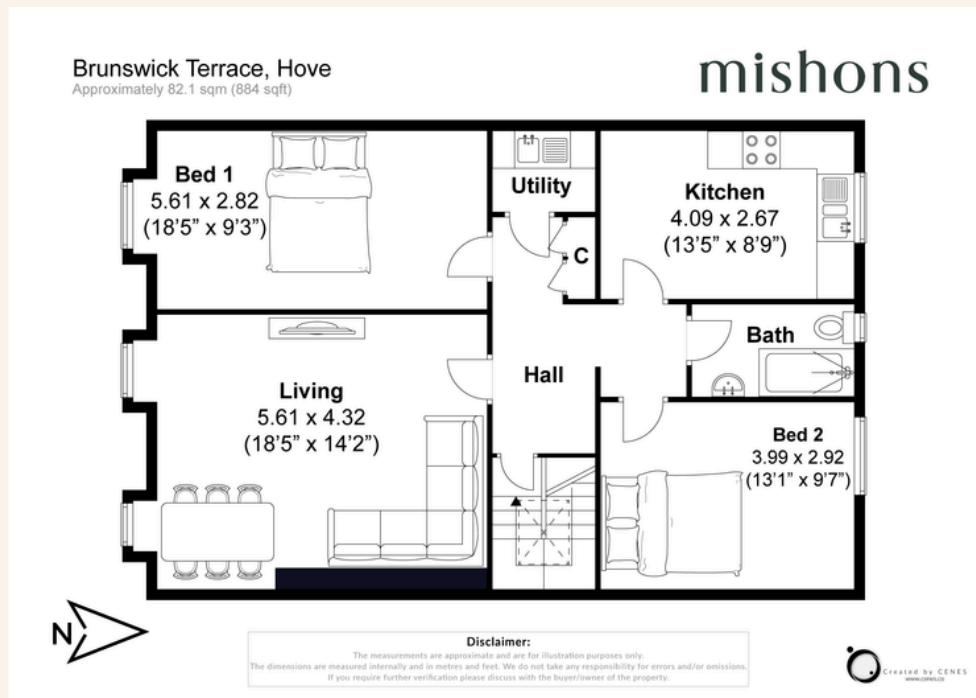



Whatever you're looking for...  
*We'll help you find it.*

mishons

✉ [sales@mishons.com](mailto:sales@mishons.com)

☎ 01273 77 88 77

94 Church Road, Hove, BN3 2EB

Monday-Friday: 8:45 am - 6 pm

Saturday: 9 am - 4 pm

Find us on Facebook and Instagram  
@wearemishons or visit [mishons.com](http://mishons.com)