



West Parade

Worthing

mishons



One-Bedroom Ground Floor Apartment with Sea Views – Wellesley Court, Worthing

Situated in the sought-after Wellesley Court development on Worthing's prestigious seafront, this well-presented one-bedroom ground floor apartment offers the perfect blend of coastal living and everyday convenience.

Enjoy stunning sea views from the comfort of your living room, with large windows that fill the space with natural light and frame the picturesque outlook. The apartment features a spacious double bedroom, a bright and airy living/dining area, a modern fitted kitchen, and a well-appointed bathroom.

Further benefits include allocated off-street parking, well maintained communal gardens, and secure entry. This property is ideal for first-time buyers, downsizers, or anyone seeking a weekend retreat by the sea.

Early viewing is highly recommended to fully appreciate this fantastic coastal home.

➤ *Guide Price* £180,000

1



1



1



D



TOTAL FLOOR AREA:
533 sq. ft. (49.5 sq. m.) approx

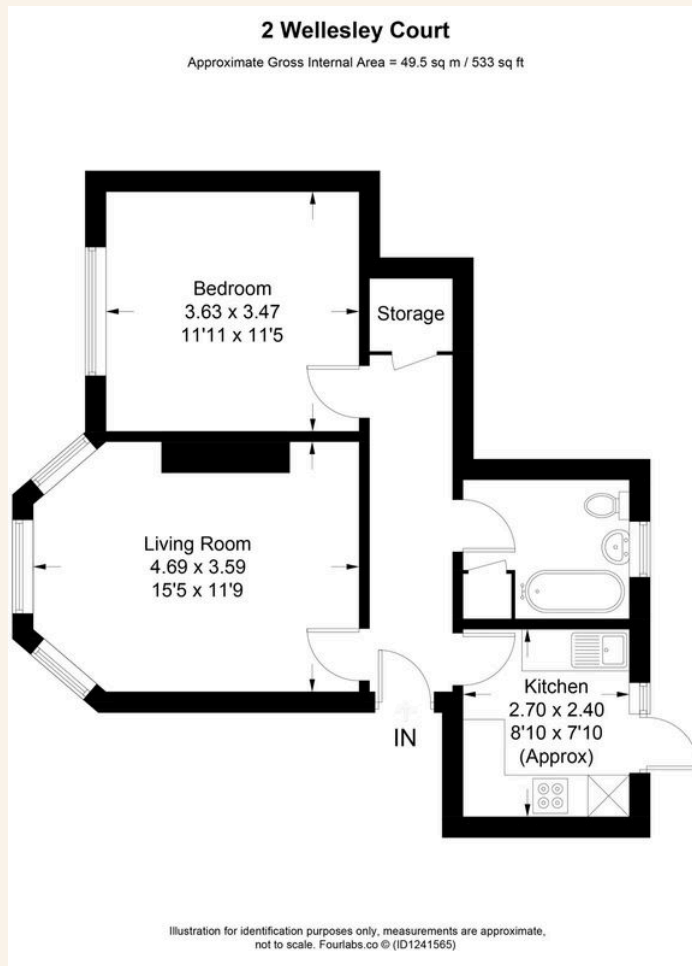



Whatever you're looking for...
We'll help you find it.

mishons

✉ sales@mishons.com

☎ 01273 77 88 77

94 Church Road, Hove, BN3 2EB

Monday-Friday: 8:45 am - 6 pm

Saturday: 9 am - 4 pm

Find us on Facebook and Instagram
@wearemishons or visit mishons.com