



Palmeira Avenue

Hove

mishons



Occupying a prime position on one of Hove's most prestigious tree-lined avenues, this impressive two-bedroom apartment forms part of an attractive period building in the heart of central Hove.

Combining elegant original features with wonderfully proportioned rooms, the property enjoys a highly sought-after location just moments from the seafront, Hove Lawns and the excellent selection of cafés, restaurants and independent shops along Church Road.

The standout feature is the magnificent open-plan living and dining room, a beautifully light and spacious space with high ceilings, ornate cornicing, a large sash window and an attractive working fireplace, creating an ideal setting for both entertaining and everyday living. The separate kitchen is fitted with contemporary units and offers ample storage and worktop space.

Both bedrooms are generous doubles, with the principal bedroom benefitting from extensive built-in wardrobes and a feature fireplace. The second bedroom is equally well-proportioned and is served by a spacious family bathroom.

Throughout the apartment, the character and scale synonymous with period homes are evident, with tall ceilings, large sash windows and decorative detailing enhancing the sense of light and space.

Palmeira Avenue is widely regarded as one of Hove's finest addresses, ideally situated within easy reach of the beach, Hove Station and the vibrant amenities of Church Road, making this a wonderful home for those seeking period elegance and a prime central location.

➤ *Guide Price* £550,000-£575,000

2



1



1



D



TOTAL FLOOR AREA:
1125 sq. ft. (104.5 sq. m.) approx

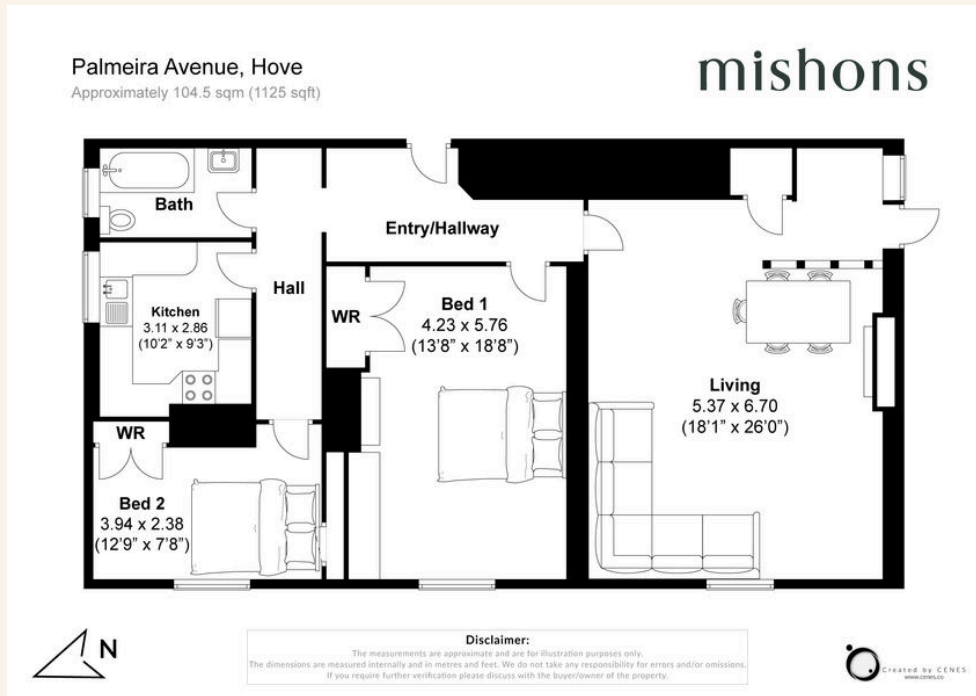



Whatever you're looking for...
We'll help you find it.

mishons

✉ sales@mishons.com

☎ 01273 77 88 77

94 Church Road, Hove, BN3 2EB

Monday-Friday: 8:45 am - 6 pm

Saturday: 9 am - 4 pm

Find us on Facebook and Instagram
@wearemishons or visit mishons.com