



Highdown Road

Hove

mishons



A beautifully presented two-bedroom garden flat, ideally positioned in a fantastic location in Seven Dials with the station close by.

Offering a seamless blend of period charm and contemporary styling, this well-laid-out home is full of thoughtful details and stylish touches throughout.

The bright and spacious living room features a large bay window, stripped wooden floors, a characterful feature fireplace, and built-in shelving and storage on either side—perfect for both entertaining and relaxing.

The chic black and brass kitchen has been thoughtfully designed to maximise space and style, while the generous bathroom boasts a sleek all-white suite, complete with a large walk-in shower.

The principal bedroom is a good-sized double with ample space for a large wardrobe. The second bedroom, currently used as a home office, opens directly onto a gorgeous, secluded garden. This outdoor space includes a decked seating area and is perfect for summer evenings or peaceful morning coffee.

Further benefits include useful storage cupboards, a private entrance, and a warm, welcoming community feel in a sought-after residential street. Just moments from Seven Dials' vibrant mix of independent cafes, shops and bars, and a short walk to the city centre and seafront, this flat is ideal for commuters, professionals, or those looking for a stylish home with outside space.

➤ **Guide Price** £425,000-£450,000

2



1



1



D



TOTAL FLOOR AREA:
725 sq. ft. (67 sq. m.) approx

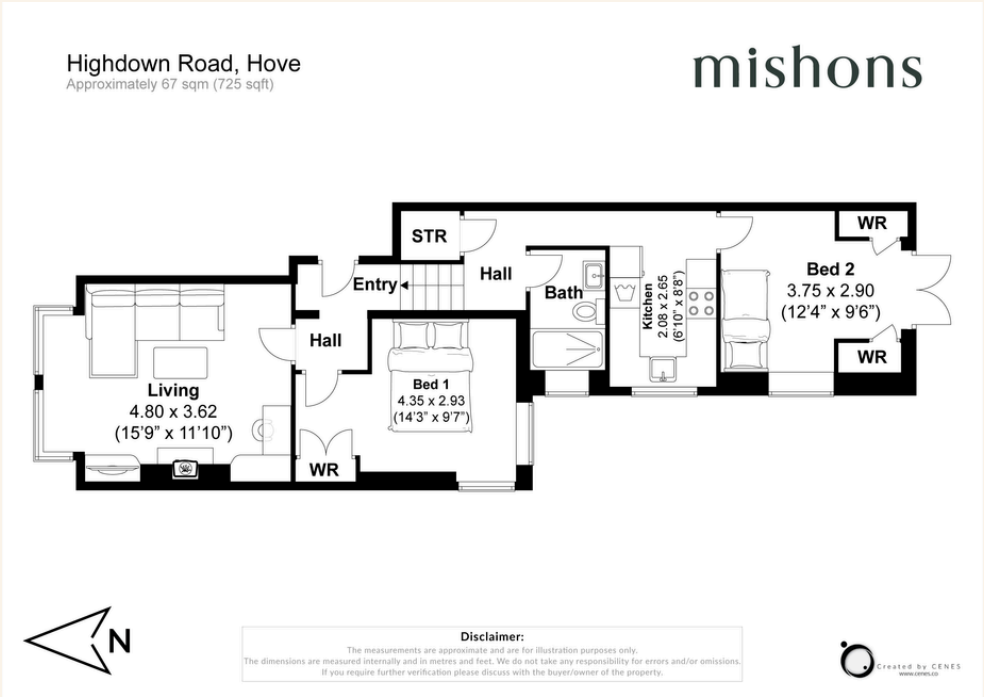



Whatever you're looking for...
We'll help you find it.

mishons

✉ sales@mishons.com

☎ 01273 77 88 77

94 Church Road, Hove, BN3 2EB

Monday-Friday: 8:45 am - 6 pm

Saturday: 9 am - 4 pm

Find us on Facebook and Instagram
@wearemishons or visit mishons.com