



Farm Road

Hove

mishons



Elegant One-Bedroom Basement Flat with Separate Living Room in Central Brighton

Tucked away on a quiet residential street in the heart of Brighton, this beautifully presented 1-bedroom basement flat offers a rare combination of space, character, and an unbeatable location.

Situated within a charming period townhouse, this property benefits from its own private entrance, well-defined living spaces, and easy access to all the best that Brighton has to offer.

As you enter the property via a private stairwell, you're welcomed into a spacious hallway that leads to each room, giving the flat a sense of flow and separation rarely found in basement apartments. The separate living room is generously sized with soft lighting, and a warm, inviting atmosphere. Large sash windows bring in natural light from the front lightwell, making this a perfect space for relaxing, hosting friends, or working from home.

The bedroom, located at the front of the property is a true retreat. It comfortably fits a double bed with ample room for wardrobes, side tables, and additional storage.

One of the unique advantages of this flat is its clear separation of living, sleeping, and dining areas, offering a more traditional and homely layout than most open-plan apartments. Despite being a basement property, it feels light, spacious, and well-ventilated, thanks to thoughtful design and well-placed windows throughout.

Located just a short stroll from Brighton Station, the flat is perfect for commuters, while the beach, Churchill Square shopping centre, and the eclectic cafes, pubs, and independent stores of North Laine and Seven Dials are all within easy walking distance.

With everything on your doorstep yet tucked away enough for peace and quiet, this flat strikes the perfect balance.

➤ *Asking Price* £300,000

1



1



1



C



TOTAL FLOOR AREA:
497 sq. ft. (46 sq. m.) approx

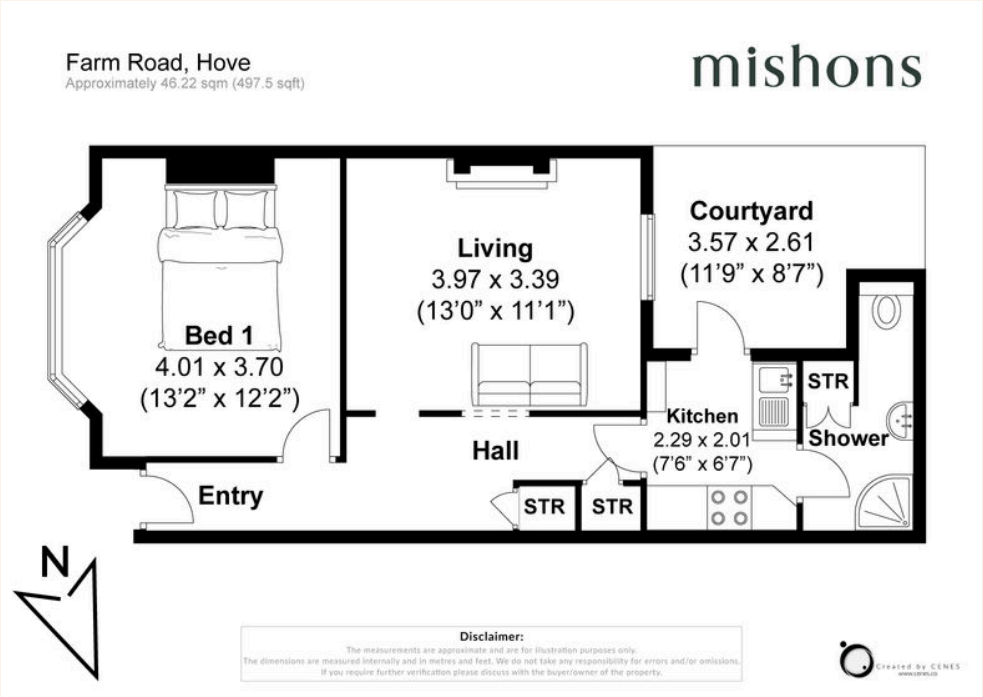



Whatever you're looking for...
We'll help you find it.

mishons

✉ sales@mishons.com

☎ 01273 77 88 77

94 Church Road, Hove, BN3 2EB

Monday-Friday: 8:45 am - 6 pm

Saturday: 9 am - 4 pm

Find us on Facebook and Instagram
@wearemishons or visit mishons.com