



Wilbury Villas

Hove

mishons



Mishons are delighted to present this generously proportioned two-bedroom second-floor flat, occupying the entire top floor of an attractive semi-detached Edwardian conversion, perfectly positioned on the prestigious Wilbury Villas – one of Hove’s most sought-after tree-lined streets.

Beautifully light and airy throughout, this charming home offers a welcoming entrance hall, a spacious 16' living room, a separate 9' fitted kitchen, two large double bedrooms, and a well-appointed bathroom suite. Blending period character with comfortable living space, this property presents an exceptional opportunity for buyers looking for a stylish and well-located home.

Wilbury Villas enjoys an enviable setting close to the vibrant Seven Dials district, celebrated for its eclectic mix of independent cafés, bars, restaurants, delis, and boutique shops. The bustling Churchill Square shopping centre, the artistic North Laine quarter, and the famous Brighton & Hove seafront are also within easy reach.

For commuters, both Brighton and Hove mainline railway stations are easily accessible on foot, providing excellent transport links to London and beyond. Regular local bus routes ensure convenient access throughout the city, while nearby green spaces such as Hove Green and St Ann’s Well Gardens offer fantastic recreational facilities.

Families will appreciate the selection of highly regarded state and private schools available in the surrounding area.

Offered to the market chain free, this superb top-floor apartment combines space, style, and an outstanding location – an opportunity not to be missed.

➤ *Asking Price* £375,000

2



1



1



C



TOTAL FLOOR AREA:
755 sq. ft. (70 sq. m.) approx

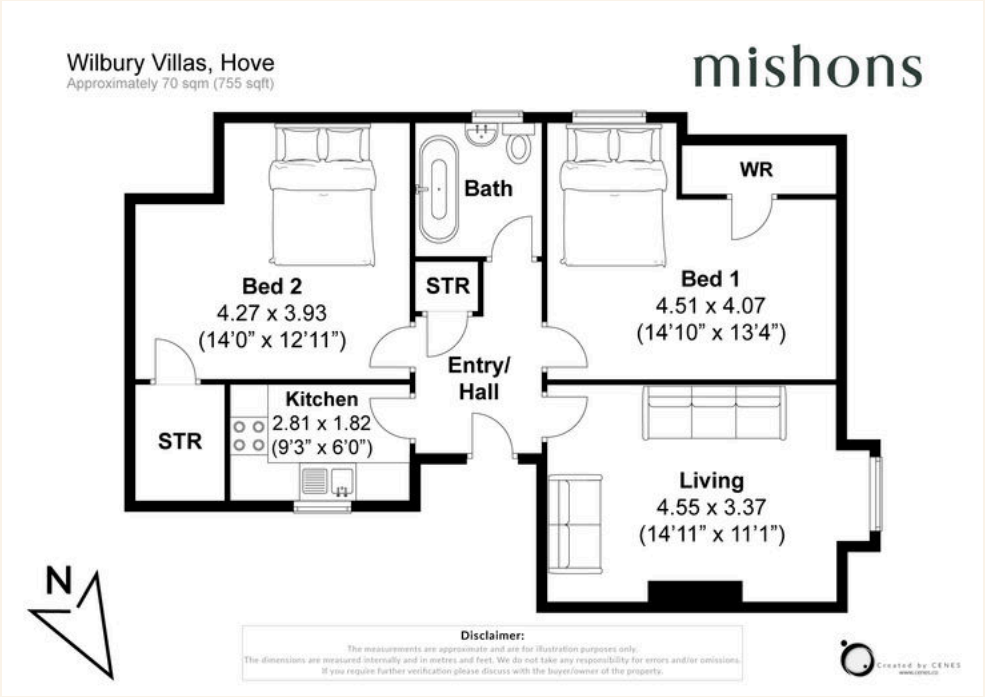



Whatever you're looking for...
We'll help you find it.

mishons

✉ sales@mishons.com

☎ 01273 77 88 77

94 Church Road, Hove, BN3 2EB

Monday-Friday: 8:45 am - 6 pm

Saturday: 9 am - 4 pm

Find us on Facebook and Instagram
@wearemishons or visit mishons.com