



# *Embassy Court*

Hove

mishons





## Set within the iconic Embassy Court building on Brighton's seafront, this beautifully presented one-bedroom apartment offers a rare opportunity to enjoy stylish coastal living in one of the city's most renowned addresses.

With lovely sea views from its private balcony, this light-filled flat is perfectly suited for a range of buyers, whether you're a first-time buyer, downsizer, professional, or investor seeking a prime location property.

The apartment has been thoughtfully designed to maximise space and natural light. The kitchen opens onto a spacious and bright living area, creating a sociable and welcoming layout that is perfect for both relaxing and entertaining. Large windows bathe the living space in sunshine, while the private balcony provides a perfect spot to unwind and take in the coastal atmosphere.

A generously sized double bedroom offers a peaceful retreat, complemented by a separate office area — ideal for those who need a dedicated workspace or creative studio. The bathroom is finished to a good standard, and the apartment as a whole carries a clean, neutral style that would easily suit a variety of tastes and furnishings.

Residents of Embassy Court enjoy access to excellent facilities including a concierge service and one of Brighton's best communal roof terraces, offering panoramic views across the coastline and city. The building is a celebrated example of 1930s Modernist architecture, thoughtfully maintained to balance its original charm with contemporary comforts.

Situated directly opposite the beach and a stone's throw from the i360 viewing tower, this prime location places you moments away from the cafes, shops, and restaurants of Western Road, as well as Brighton's famous Lanes and cultural hotspots. Brighton Station is within easy reach, providing excellent transport links to London and beyond.

Whether you are seeking a permanent home by the sea, a weekend getaway, or a smart investment opportunity, this fantastic Embassy Court apartment delivers an enviable lifestyle in the heart of Brighton.

➤ *Guide Price*    **£275,000**

1



1



1



tbc



## TOTAL FLOOR AREA:

619 sq. ft. (57 sq. m.) approx

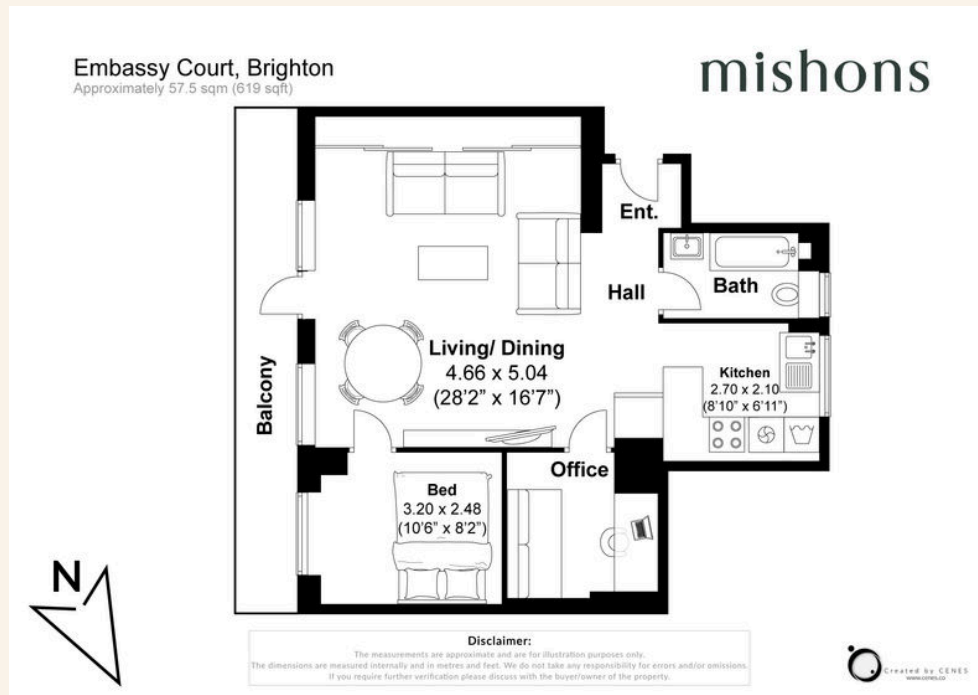





Whatever you're looking for...  
*We'll help you find it.*

mishons

✉ [sales@mishons.com](mailto:sales@mishons.com)

☎ 01273 77 88 77

94 Church Road, Hove, BN3 2EB

Monday-Friday: 8:45 am - 6 pm

Saturday: 9 am - 4 pm

Find us on Facebook and Instagram  
@wearemishons or visit [mishons.com](http://mishons.com)