



Lansdowne Road

Hove

mishons



Set on the lower ground floor of a well-positioned corner building at Salisbury Road and Lansdowne Road, this one-bedroom flat offers a smart and practical layout with the added benefits of outdoor space and allocated parking.

The accommodation is well balanced, with a generous living and dining room providing ample space for both relaxation and entertaining. Adjacent, the separate kitchen is neatly arranged with good worktop and storage provision, making it a functional and efficient space.

The bedroom is comfortably proportioned, easily accommodating a double bed along with additional furniture, while the bathroom is fitted with a full suite. A central hallway connects each room, enhancing the sense of flow throughout the property.

Externally, the flat enjoys access to a small patio area—ideal for a morning coffee or some fresh air—as well as the convenience of an allocated parking space, a valuable feature in this location.

Positioned on the corner of Salisbury Road and Lansdowne Road, the property benefits from easy access to local amenities, transport links with Hove train station just a short walk away and Hove Lawns just down the road from the property, making it an appealing choice for first-time buyers, downsizers, or investors alike.

➤ *Guide Price* £280,000-£300,000

1



1



1



tbc



TOTAL FLOOR AREA:
643 sq. ft. (59.7 sq. m.) approx

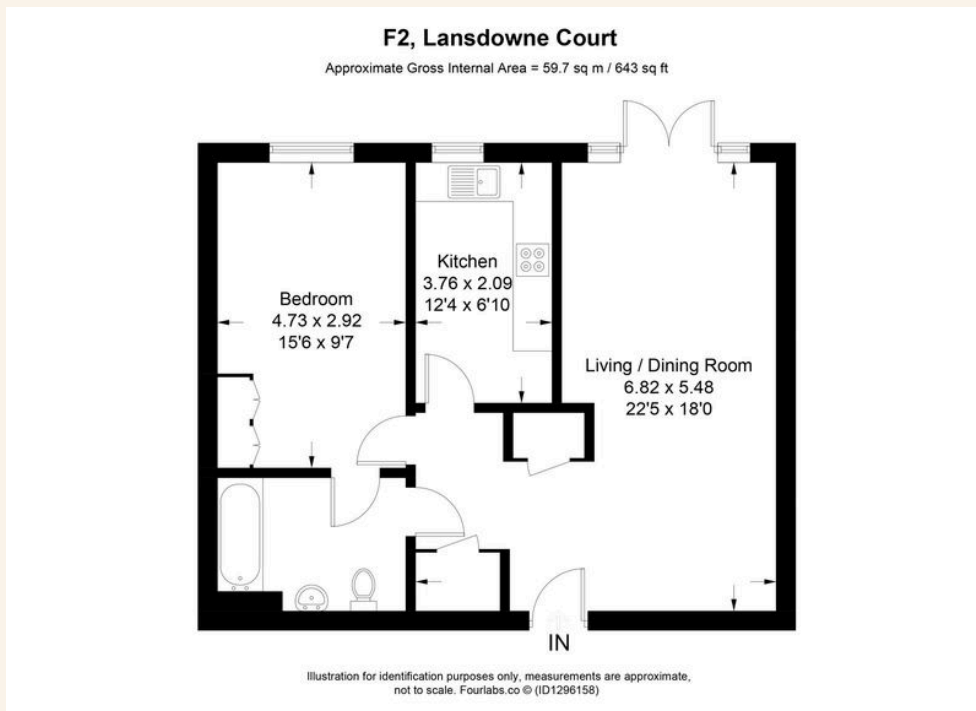



Whatever you're looking for...
We'll help you find it.

mishons

✉ sales@mishons.com

☎ 01273 77 88 77

94 Church Road, Hove, BN3 2EB

Monday-Friday: 8:45 am - 6 pm

Saturday: 9 am - 4 pm

Find us on Facebook and Instagram
@wearemishons or visit mishons.com