



Vallance Gardens

Hove

mishons



Elegant 1-Bedroom Apartment in Stunning Double-Fronted Property, Vallance Gardens, Hove

Being sold with no onward chain, nestled within the sought-after Vallance Gardens, this exquisite top-floor, 1-bedroom apartment boasts a prime location just steps from Hove's beautiful seafront and a short stroll from the vibrant cafes, bars, and shops of Church Road. Set within a grand, double-fronted property, this home offers a perfect blend of character, style, and functionality.

Inside, you'll find an inviting open-plan kitchen and dining area, a spacious and separate living room filled with natural light, and a generously sized double bedroom that serves as a tranquil retreat. Additional amenities include a modern bathroom, a separate WC for convenience, and ample storage throughout the home.

With its elegant charm and peaceful atmosphere, this apartment is the ideal hideaway for unwinding after a busy day, while being perfectly positioned to enjoy the best of Hove's lively coastal lifestyle.

➤ *Offers Over* £270,000

1



1



1



C



TOTAL FLOOR AREA:
588 sq. ft. (54.6 sq. m.) approx

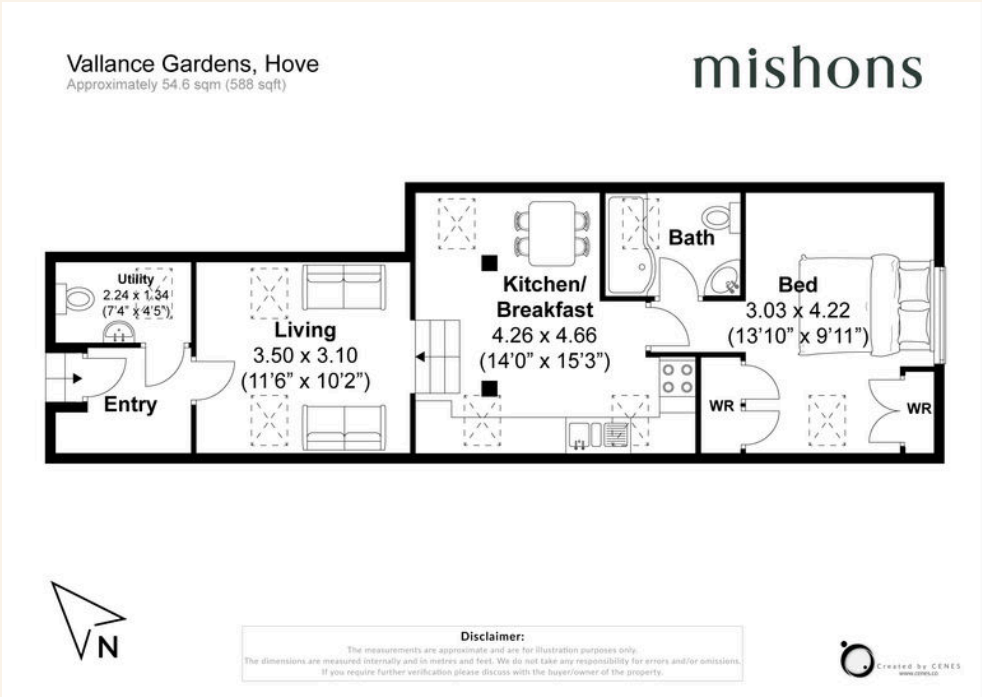



Whatever you're looking for...
We'll help you find it.

mishons

✉ sales@mishons.com

☎ 01273 77 88 77

94 Church Road, Hove, BN3 2EB

Monday-Friday: 8:45 am - 6 pm

Saturday: 9 am - 4 pm

Find us on Facebook and Instagram
@wearemishons or visit mishons.com