



# *Glenside, Dukes Place*

Hassocks, BN6 9FJ

mishons





# This four bedroom detached family home is situated in the...

...idyllic village of Sayers Common in West Sussex. This is a ideal spot for a young family.

As you enter the home, the downstairs is a fabulous space. The kitchen/breakfast room is a great place to spend time with the family or guests sitting down for dinner.

The sitting room is a quiet, peaceful spot to relax. Our favourite room in the house is the family room at the back of the house leading to the super garden. With lots of natural light coming through this is a great spot.

Upstairs there are four bedrooms and two bathrooms. The main bedroom is a spacious room with a stylish en-suite. The second bedroom is also a good size perfect for a teenager or guest room.

Sayers Common is a great village just a short drive from Hurstpierpoint. Perfectly position for the A23 with excellent access to south takes you to Brighton, or Crawley, Gatwick Airport and the M25 to the north. Down the road you'll find The Community Shop – a great place to get your daily needs and a thriving part of the local area.

The Duke of York is the nearest pub and one of our favourites in Mid-Sussex is The Bull Inn which about a 10 minute drive. There is plenty of open countryside that surrounds Sayers Common with public footpaths and bridleways. Local schools would be Twineham C of E, Albourne C of E or St. Lawrence Primary in Hurstpierpoint.

The High Street of Hurstpierpoint is vibrant, with an array of local shops and restaurants. For commuters, Haywards Heath mainline station and Burgess Hill mainline station are within seven and five miles.

 Offers IEO £500,000

4



3



2



TBC



**TOTAL FLOOR AREA:**  
1195.22 sq. ft. (111.04 sq. m.) approx

Approximate Gross Internal Area = 111.04 sq m / 1195.22 sq. ft

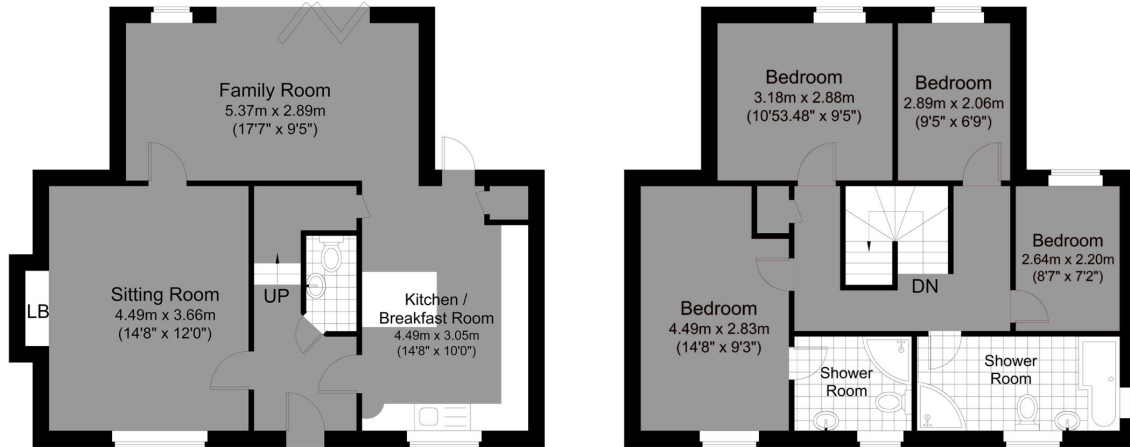

## 6 Dukes Place

Ground Floor  
Approximate Floor Area  
597.61 sq. ft (55.52 sq. m)

First Floor  
Approximate Floor Area  
597.61 sq. ft (55.52 sq. m)

Illustration for identification purposes only, measurements are approximate, not to scale.







Whatever you're looking for...  
*We'll help you find it.*

mishons

✉ [sales@mishons.com](mailto:sales@mishons.com)

☎ 01273 77 88 77

94 Church Road, Hove, BN3 2EB

Monday-Friday: 8:45 am - 6 pm

Saturday: 9 am - 4 pm

Find us on Facebook and Instagram  
@wearemishons or visit [mishons.com](http://mishons.com)