

The Cliff,
Brighton, BN2 5RE

guide price

£800,000

mishon
welton

[mishonwelton.com](https://www.mishonwelton.com)





share of freehold

A unique opportunity to purchase a superb three bedroom and two reception room, ground floor apartment with direct views over the sea.

The property itself offers over 2,000 SQ FT with the added benefit of a separate garage and two parking spaces.

The property has been finished to a modern standard throughout, complete with contemporary tones and furnishings. As you enter, you are immediately struck by the vast hallway which provides a wealth of natural, south facing light. The kitchen is in great order and provides ample worktop and surface space. The large living room, can be directly accessed from the kitchen, providing an open plan, social feel. From the fantastic living room, is a separate dining room...ideal for hosting your guests on the weekend.

The three bedrooms are all large doubles, all benefiting from the direct sea vistas. The principle bedroom is worthy of particular mention with it's own dressing room and lovely feature bay window. The second bedroom also benefits from an en-suite shower room, with dual aspect windows. There is also a separate family bathroom and W.C

This apartment spans incredible width and boasts amazing dimensions and proportions internally. All rooms are of a great size and with direct sea views from every room, you certainly won't get bored of living here! White Lodge is located in Roedean, an extremely desirable residential area within Brighton, with easy access into the City Centre.



exceptional service

Our team will guide you through the process of buying or selling your home.

We have a team of dedicated sales progressors in place to ensure your purchase or sale runs smoothly through to completion, keeping you in the loop and a close eye on your chain while moving you in as swiftly and smoothly as possible.

- Honest valuations in current market conditions
- Dedicated sales progression team
- Recommended financial advisors
- 5* service from valuation to completion
- Award winning lettings service
- Ahead of the game marketing strategies
- Professional photography
- Social media marketing
- Top listings on Rightmove and Zoopla

call us for a free
valuation on your
property

sales@mishonwelton.com

Church Road | Hove | BN3 2EB

The Cliff, Brighton

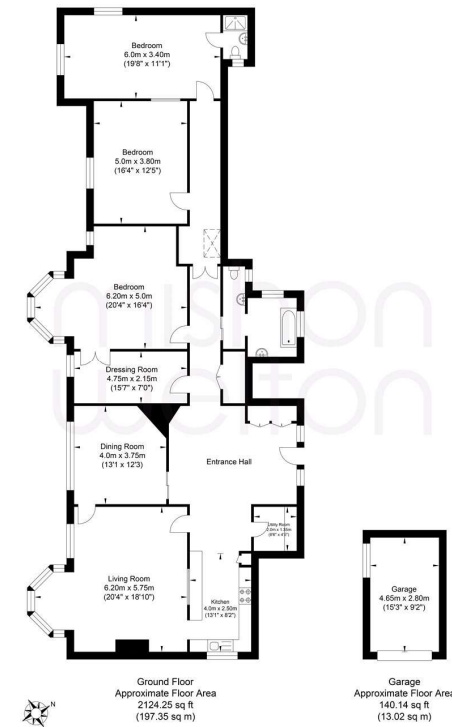

Approximate Gross Internal Area = 210.37 sq m / 2264.40 sq ft
Illustration for identification purposes only, measurements are approximate, not to scale.
Copyright GDImpact 2021

Mishon Welton & their clients give notice that:

1. These sales and particulars do not constitute any part of an offer of contract, and are for the guidance of prospective purchasers only and should not be relied on as statements of fact.
2. No representations are made in these particulars as to the condition of the property or as to whether any service or facilities are in good working order.
3. All Measurements are approximate.

Zoopla

PrimeLocation

rightmove